

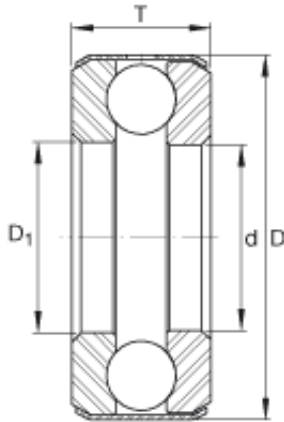

Liaocheng City Hsn Bearing Co., Ltd.



Poly F Plus B28 V-Belt NEW

Bearing No. B28

B28 Bearing 2D drawings and 3D CAD models

Size	55.563x91.29x22.22 mm
Bore Diameter	55,563 mm
Outer Diameter	91,29 mm
Width	22,22 mm
d	2 3/16 inch
d	55,563 mm
D	3,594 inch
D	91,29 mm
T	0,875 inch
T	22,22 mm
D ₁	2,219 inch
m	1,14 lbs / Weight
m	0,517 kg / Weight
C _a	13600 lbf / Dynamic load rating (axial)
C _a	60000 N / Dynamic load rating (axial)
C _{0a}	34000 lbf / Static load rating (axial)
C _{0a}	151000 N / Static load rating (axial)
Category	Thrust Ball Bearing
Inventory	0.0
Manufacturer Name	SCHAEFFLER GROUP
Minimum Buy Quantity	N/A
Weight / Kilogram	0.619
Product Group	B00308



Liaocheng City Hsn Bearing Co., Ltd.

Rolling Element	Ball Bearing
Thrust Bearing	Yes
Single or Double Direction	Single Direction
Banded	Yes
Cage Material	Steel
Precision Class	ABEC 1 ISO P0
Component Description	Roller Assembly Plus Raceways
Other Features	Single Row With Flat Seat
Long Description	2-3/16" Bore 1; 2-7/32" Bore 2; 3-19/32" Outside Diameter; 7/8" Height; Ball Bearing; Single Direction; Banded; Steel Cage; ABEC 1 ISO P0 Precision
Inch - Metric	Inch
Category	Thrust Ball Bearings
UNSPSC	31171552
Harmonized Tariff Code	8482.10.50.08
Noun	Bearing
Keyword String	Ball Thrust
Manufacturer URL	http://www.ina.com
Bore 2	2.219 Inch 56.363 Millimeter
Outside Diameter	3.594 Inch 91.288 Millimeter
Height	0.875 Inch 22.225 Millimeter
Bore 1	2.188 Inch 55.575 Millimeter
Overall Height with Aligning Washer	0 Inch 0 Millimeter